

* H2 Interior Hard Surface Cleaner

Jangro *



BB455-1



Paintwork, Laminate, Glass Mirrors and Hard Surfaces:

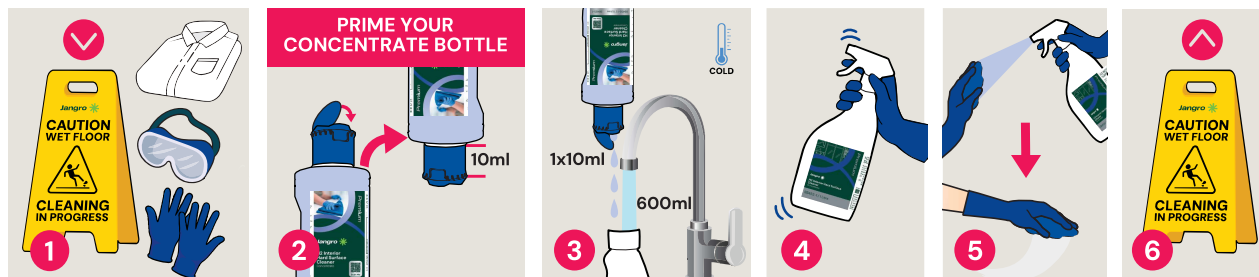

Place safety signs & use the appropriate PPE as indicated in the Safety Data Sheet.

Close cap, invert the bottle for a few seconds. Turn the bottle upright & dosing cap is primed with 10ml of solution.

Add 1 x 10ml from dosing cap to 600ml cold water in trigger spray bottle.

Gently shake to mix.

Spray onto cloth and wipe surface.

Remove Safety Signs when safe to do so.

Damp Mopping and General Cleaning:

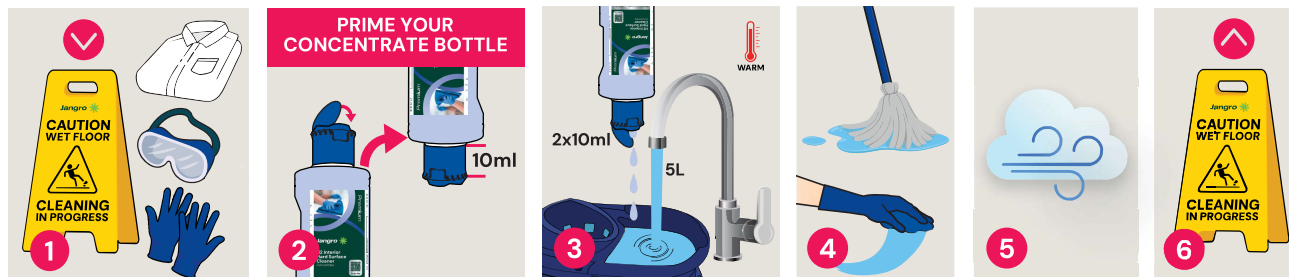

Place safety signs & use the appropriate PPE as indicated in the Safety Data Sheet.

Close cap, invert the bottle for a few seconds. Turn the bottle upright & dosing cap is primed with 10ml of solution.

Add 2x 10ml from dosing cap to 5 litres warm water in a bucket.

Mop or wipe surface.

Allow to air dry.

Remove Safety Signs when safe to do so.

Areas for use



Health & Safety
Please refer to relevant COSHH Safety Data Sheet

www.jangro.net

Scan QR code for further product details



Causes severe eye damage.
May cause an allergic skin reaction.

Premium

Product Usage Guide